



Serie

Stilo - 50 RPT

Especificaciones Técnicas

Carpintería practicable con Rotura de Puente Térmico

Cámara Europea

Junta abierta con Junta Central

Sección de Marco 43 mm.

Sección de Hoja 50 mm.

Galce de vidrio de 10,5 a 44 mm.

Peso Máximo por : Hoja Practicable : 120 Kg.⁽¹⁾

Hoja Oscilo- Batiente : 130 Kg.⁽¹⁾

Hoja Oscilo- Batiente con opción de Herraje Oculito

Medidas Máximas por Hoja para todas las aperturas :

1700 mm. x 2500 mm.⁽¹⁾

(1) Consultar rangos de aplicación con nuestro Dpto. Técnico Comercial

Clasificación obtenida

Permeabilidad al aire*	CLASE 4
Estanqueidad al agua*	CLASE E1200
Resistencia al viento*	CLASE C5
Transmitancia térmica**	1,6 W(m ² K)
Aislamiento Acústico***	38 (-1;-5)dB

* Ventana de 2 hojas de 1230 x 1480 mm .

** Ventana de 2 hojas de 1480 x 2180 mm ; Vidrio Uv: 1,0 W(m²K)

*** Ventana de 2 hojas de 1230 x 1480 mm ; Vidrio Rw: 40 (-2,-6)dB

Posibilidades de Apertura

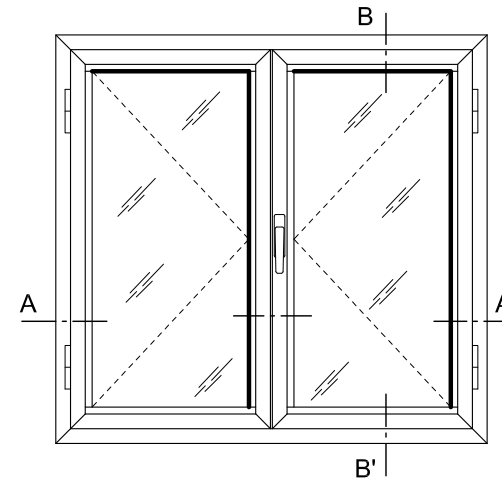
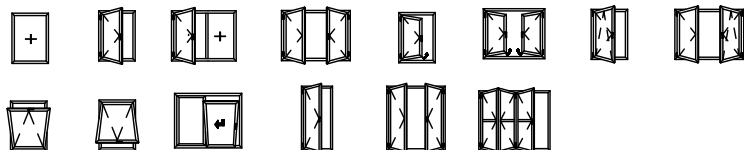

VENTANA 2 HOJAS PRACTICABLES

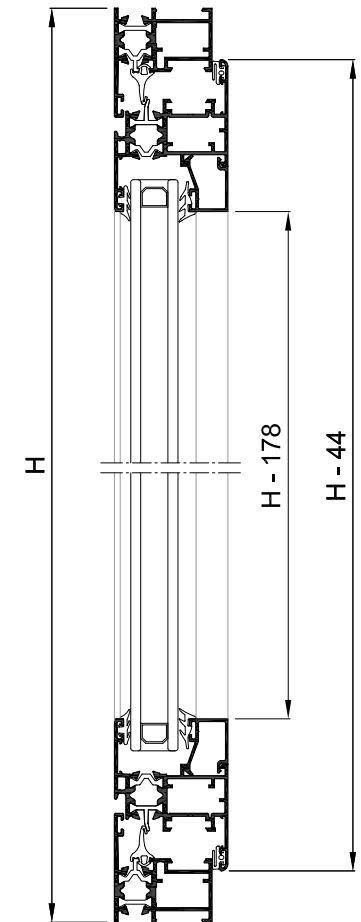

Sección B-B'

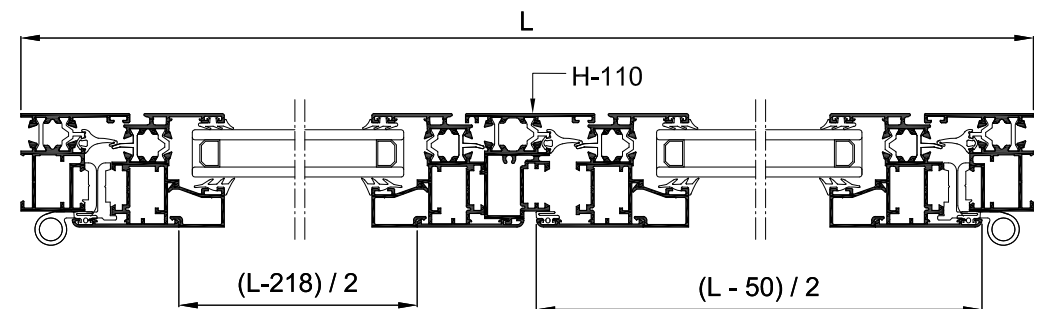

Sección A-A'

* Tabla de Junquillos 1 (Altura 20 mm)

Perfiles

Stilo - 50 RPT

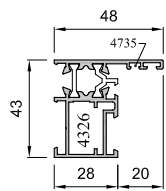

8855M

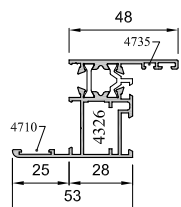

8870M

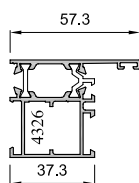

8802M

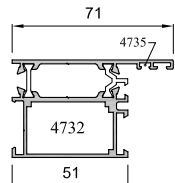

8873M

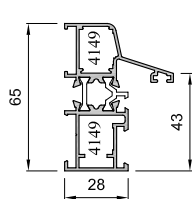

8897M

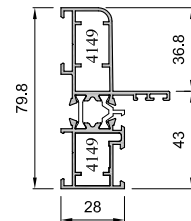

8062M

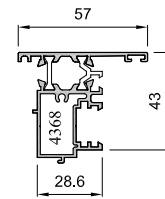

8808M

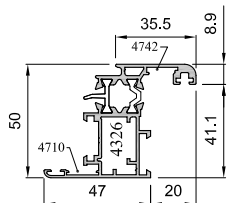

8852M

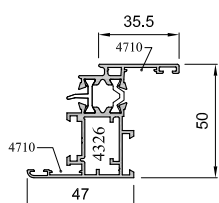

8888M

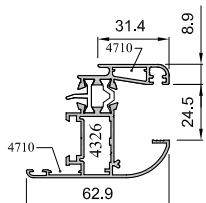

8805M

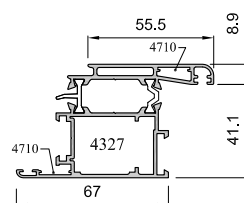

8806M

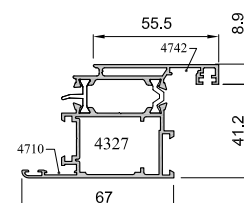

8895M

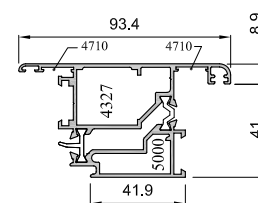

8898M

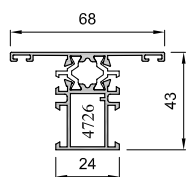

8865M

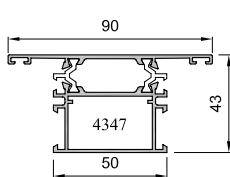

8810M

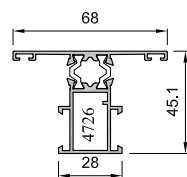

8866M

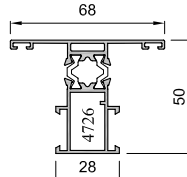

8817M

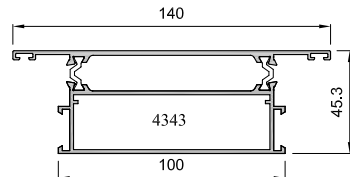

MANGUETÓN
8246M

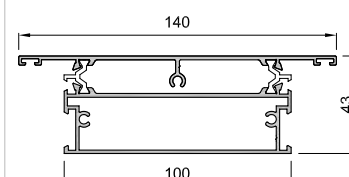

ZÓCALO
8892M

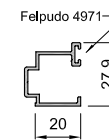

Felpudo 4971
8891

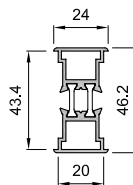

8268M

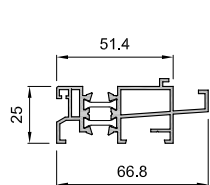

8273M

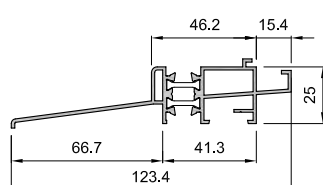

8286M

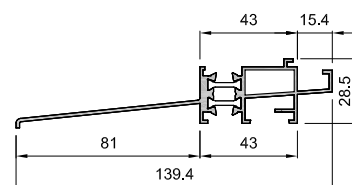

8837M

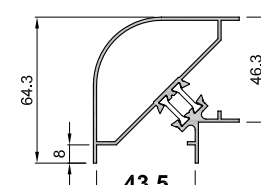

8290M

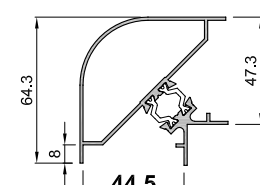

8290L



8412

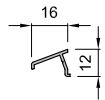

8428

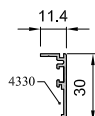

281
1140

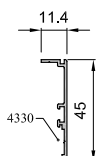

8629

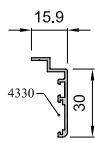

8832

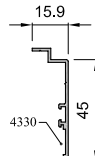

8630



Accesorios

Stilo - 50 RPT



4024
Cremona EURO

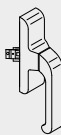

4019
Cremona EURO
Os-Ba

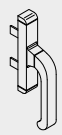

4200
Cremona
Nova

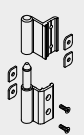

4316
Bisagra apertura
externa

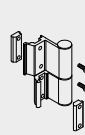

4390
Bisagra regleta
Ø 14 mm.



4724
Bisagra Os-Ba
Simétrica 2º Hoja



4739
Terminal pletina
metálico



4840
KIT Pasador hoja
pasiva metal.
(sup. e inf.)



4025
Kit Cremona
EURO



4010
Bisagra compás
corto ralenti



4085
Bisagra compás
largo ralenti



4846
Tercer punto
de cierre



4710
Escuadra
alineamien.
14 mm.



4735
Escuadra
alineamien.
2 mm.



4742
Escuadra
alineamiento
excéntrica



4326
Escuadra
Cercos y Hoja



4327
Escuadra
Hoja balconera



4732
Escuadra
Cercos balconera



5002
Cierre suplem.
entre hojas



4720
Cerradero lateral
doble pletina
Zamak



4842
Cerradero sup.
regulable
OS-BA



4726
Taco Stilo
pilastra 28 mm.



4347
Taco Stilo
pilastra ancha



4343
Taco Stilo
manguetón

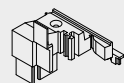

4368
Tapas acople
St-50 RPT



4369
Junta
central



4055
Junta perim.
hoja



4008
Patin apoyo hoja



4337
Embelle. salida agua
c/ membrana



4833
Cremona
practicable cover



4834
Cremona os-ba
Cover



4725
Cremona Prima
Os-Ba

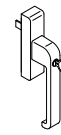

4096
Cremona Os-Pa
con llave

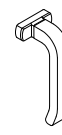

4398
Manilla
recuperable

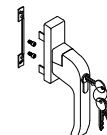

4707
Cremona EURO
c/ llave



4723
Cremona Prima

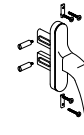

1034
Cremona ap. Ext.
patillas Balcon.



1044
Cierre presión
(Pequeño)

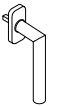

5079
Manilla inox.
recta

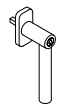

5080
Manilla inox
recta c/llave



5086
Manilla inox
recta acodada



4613
Mecanismo Cuadrad.
bidirec. practicable



5081
Mecanismo
Cuadrad. OS. BA.

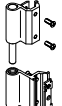

4727
Bisagra Flash
Izquierda/Derecha

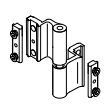

4768
Bisagra
3º Hoja

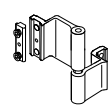

4769
Bisagra Extremo
"Jirafa"

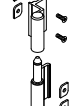

4352
Bisagra ventana
3 hojas

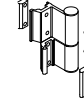

4389
Bisagra regleta
Ø 16 mm.

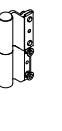

4744
Bisagra Puerta
24,5 mm. Izda.

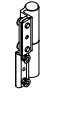

4745
Bisagra Puerta
24,5 mm. Dcha.

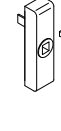

4079
Kit Cremona desmont.
Os-Pa > 2000 mm.

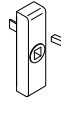

4365
Kit cremona desmont.
OS-PA < 2000 mm.



4002
Pasador oculto
long. variable

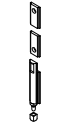

4003
Terminal de
pletina cremona

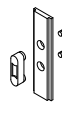

4007
Cierre complem.
cre mona

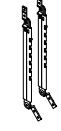

4011
Bisagra compás regul.
proyectante

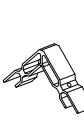

5000
Escuadra
Ap.Externa

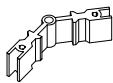

4708
Escuadra ángulo
variable



4039
Escuadra inox.
alineamiento



4304
Escuadra
alineam. solapas



4330
Escuadra alineamien.
15 mm.



4855
Escuadra solapa
8893



4356
Broca doble diámetro
(s/junquillo)



4353
Kit acristalami.
s/junquillo
(2 A + 2 B)



4009
Cierre cangrejo
Interno



4366
Cierre bisagra
oculta



4754
Retenedor
de hoja



4848
Microventilacion
practicable



5026
Bulón regulable



4005
Cerradero lateral
pletina Nylon



4004
Cerradero lateral
doble pletina Nylon



4078
Pieza sujeción
junquillo curvo



4391
Escuadra
junquillos curvos

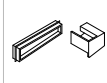

4043
Juego tapas
condensación



4035
Embellecedor
salida agua



4370
Junta central
7°C"



4854
Escuadra
vulcanizada



4056
Junta perimetral
hoja "TC"



4397
Junta Stilo
base rígida



4379
Junta acústica
cerco



4303
Junta acústica
cerco



4741
Goma para
batiente



5015
Plantilla escuadra
ap.exterior RPT



4057
Goma exterior
acristalamiento



4089
Goma interior
acrist. de 2 a 4
mm.



4090
Goma interior
acrist. de 4 a 6
mm.



4091
Goma interior
acrist. de 6 a 8
mm.

Accesorios Varios

- 4388** Juego Fresas Hoja St-50 RPT
- 4387** Juego fresas Cercos St-50 RPT
- 4062** Util General STILO
- 4841** Util Multiple practicable
- 4201** Kit Cremona Nova
- 4025** Kit Cremona EURO
- 4380** Kit Cremona EURO 2 hojas (si/cremona)
4002x2 + 4003x2 + 4025 + 4004x2 + 4008
- 4714** Kit Cremona EURO 1 hoja
4003x2 + 4025 + 4005x2
- 4334** Tijeras ingleses goma
- 4335** Ruleta para goma
- 1161** Patillas
- 4098,4099,4357**
- 4373,4374,4758** Cerraduras ST-50 RPT
- 4862** Cerradura Apertura externa
- 5001** Util escuadra exterior
- 5022** Cremona Industrial Prima
- 5023** Cremona Industrial Euro
- 5024** Herraje Os-Ba Industrial

